

Contents:

GROUP 4 - 4.1 - Elektra Lighting Products



The recessed lights below show the various colours available. Original colours may vary from the photo due to the printing process.

Colour	Code
white	01
polished chrome	02
black	04
brass	09
satin nickel	22
satin chrome	33



Radiation angle Halogen bulb



Halogen lamp



Minimal distance to inflammable material



Drill hole for installation



Dimensions of installation



Tube diameter



ECO light 12V/10W
 - clear glass diffuser
 - 2000mm lead with plug
 - push-fit installation

- E561 054 01 white
- E561 054 02 polished chrome
- E561 054 04 black
- E561 054 22 satin nickel

Dimensions of installation
 Ø 55mm
 D 16mm

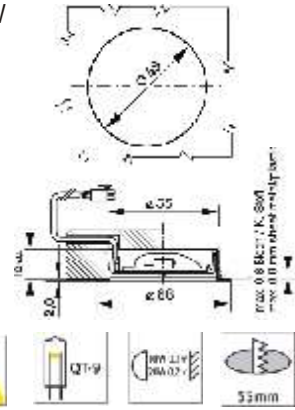

ECO light 12V/20W
 - opal glass diffuser
 - 2000mm lead with plug
 - push-fit installation

- E561 014 01 white
- E561 014 02 polished chrome
- E561 014 04 black
- E561 014 22 satin nickel

Dimensions of installation
 Ø 55mm
 D 16mm

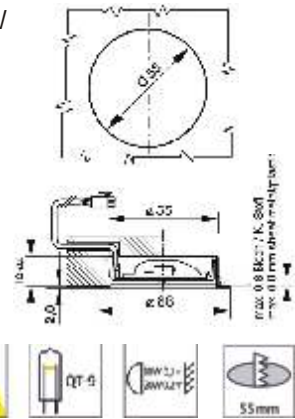

Fitted light 12V/10W
 - opal glass diffuser
 - 2000mm lead with plug
 - screw installation

- E563 274 01 white
- E563 274 02 polished chrome

Dimensions of installation
 Ø 58mm
 D 14mm

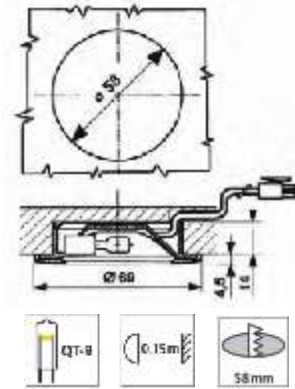

Fitted light 12V/20W
 - clear glass diffuser
 - 2000mm lead with plug
 - screw installation

- E563 124 01 white
- E563 124 02 polished chrome

Dimensions of installation
 Ø 58mm
 D 14mm

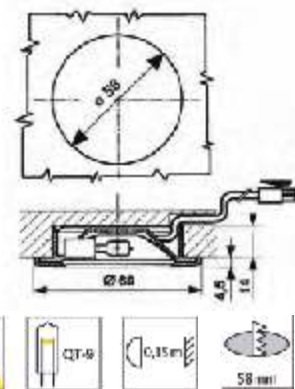

> Elektra Lighting Products



Light housing triangle S/steel
 - decorative element: stainless steel
 - screw installation

E531 199 01 stainless steel

Dimensions of installation
 L 122mm
 W 130mm
 H 40mm

Suitable with ECO lights

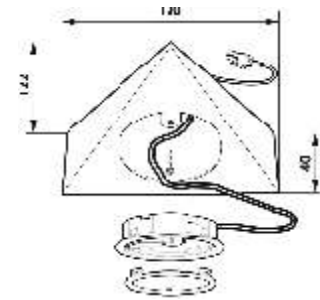

Light housing rectangle S/steel
 - decorative element: stainless steel
 - screw installation

E531 209 22 stainless steel

Dimensions of installation
 L 147mm
 W 82mm
 H 77mm

Suitable with ECO lights

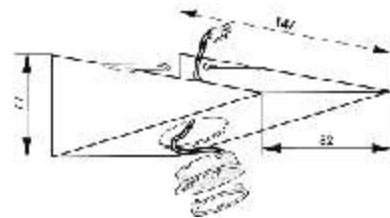

Surface ring
 - height of cover ring 22 mm
 - Ø 68 mm

E525 820 02 polished chrome
 E525 820 22 satin nickel

Suitable with ECO lights



Fitted light 12V/10W
 - decorative bezel fully adjustable
 - opal glass diffuser
 - push-fit installation

E561 464 02 polished chrome
 E561 464 22 satin nickel

Dimensions of installation
 Ø 55mm
 D 13mm

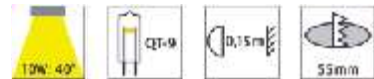
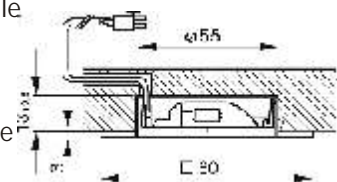

Fitted light 12V/20W
 - decorative bezel fully adjustable
 - opal glass diffuser
 - push-fit installation

E561 474 02 polished chrome
 E561 474 22 satin nickel

Dimensions of installation
 Ø 55mm
 D 13mm

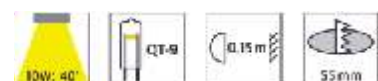
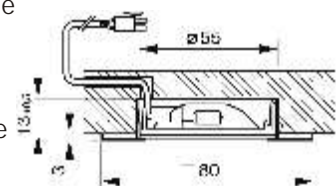

> Elektra Lighting Products



Cornice light 12V/20W
 - tube \varnothing 8 mm
 - dichroic reflector bulb
 - light head 180° rotatable
 - 90° swivelling
 - 200 mm connecting lead with plug
 - screw installation

E523 335 02 polished chrome
 E523 335 22 satin nickel

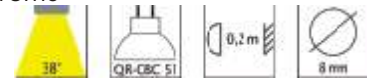

5 way terminal block
 - for connection of max. 6 lights
 - 155 mm lead

E522 090 02 white



Micro switch
 - open when switch is activated

E513 307 02 white



Possum transformer
 240V/12V/35-60VA

ETED-60A

Possum transformer
 240V/12V/35-105VA

ETED-105A

- more powerful
 - leading edge technology

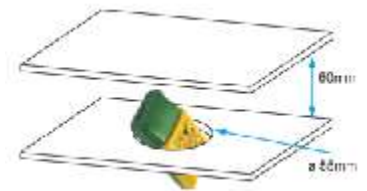

LD 5000 Series



Recessed-mounted light 6W
Quadra A
 230V 50/60Hz
 - decorative ring translucent/spheric
 - fluorescent tube Light Disc Opal
 - push-fit installation

E532 891 10 translucent

Dimensions of installation
 \varnothing 78; D 22mm

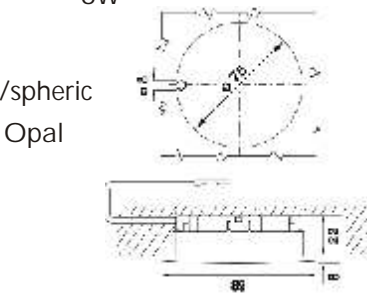

Recessed-mounted light 6W
Rondo B
 230V 50/60Hz
 - decorative ring cylindrical
 - fluorescent tube Light Disc Opal
 - push-fit installation

E532 898 02 polished chrome
 E532 898 22 satin nickel

Dimensions of installation
 \varnothing 78; D 13mm

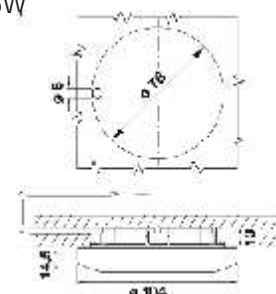

Elektra Lighting Products

Group 4
4.1

LD 5000 Series



Surface-mounted light 6W
 Rondo E
 230V 50/60Hz
 - decorative ring translucent/spheric
 - fluorescent tube Light Disc Opal

E532 901 02 polished chrome
 E532 901 22 satin nickel

Dimensions of installation
 Ø 100; D 27mm

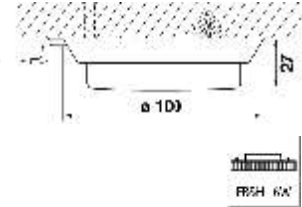

Single distributor lead
 - for connection of 1 light
 - 2 metres

E531 115 10



Distributor lead
 - 6 way distributor lead
 - 3 metres

E531 116 03

Elektra Lighting Products
Group 4
4.1



Surface mounted light 230V 50/60Hz 8W
 - 2 intergrated electronic ballast
 - switch
 - prismatic cover
 - max. 10 lights can be connected in a row
 - light colour: cool white
 - protection class II
 - connector system C7/C8

E526 020 01 white
 E526 020 63 aluminium look

Dimensions of installation
 8W L 320; W 78; H 26mm

Lead to suit	
E520 950 01	no plug
E521 329 01	with plug

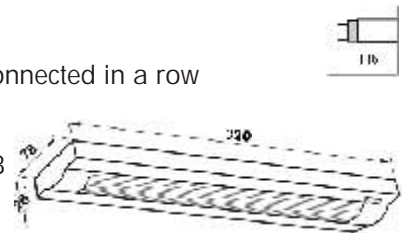

Surface mounted light 230V 50/60Hz 13W
 - 2 intergrated electronic ballast
 - switch
 - prismatic cover
 - max. 10 lights can be connected in a row
 - light colour: cool white
 - protection class II
 - connector system C7/C8

E526 050 01 white
 E526 050 63 aluminium look

Dimensions of installation
 13W - L 320; W 78; H 26mm

Lead to suit	
E520 950 01	no plug
E521 329 01	with plug

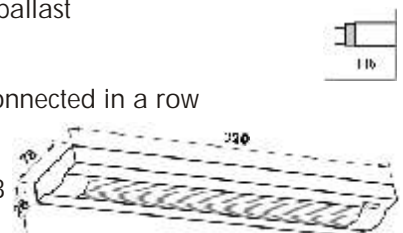

Recess-mounted light 13W
 230V 50/60Hz
 - for panels from 16 mm thickness
 - integrated electronic ballast
 - max. 10 lights in a row
 - concealed connection system C7/C8

E532 060 25 white

Dimensions of installation
 13W - L 578; W 78; H 10 mm

Lead to suit	
E520 950 01	no plug
E521 329 01	with plug

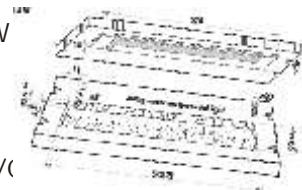



- Lighted glass-shelf box 230V 50/60Hz 13W
- anodised aluminium profile with frosted glass shelves
 - upward and downward light effect
 - switch
 - integrated electronic ballast
 - easy level adjustment by means of hand nuts
 - supply lead with mini connector system
 - protection class II
 - max. load 10kg

E531 755 01 stainless steel look
E531 755 66 aluminium

Dimensions of installation
13W L 900; W 202; H 50mm

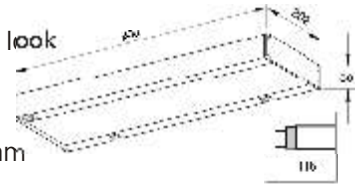

- Lighted glass-shelf box 230V 50/60Hz 13W
- anodised aluminium profile with frosted glass shelves
 - upward and downward light effect
 - switch
 - integrated electronic ballast
 - easy level adjustment by means of hand nuts
 - supply lead with mini connector system
 - protection class II
 - max. load 10kg

E531 728 01 stainless steel look
E531 728 66 aluminium

Dimensions of installation
13W L 600; W 202; H 50mm

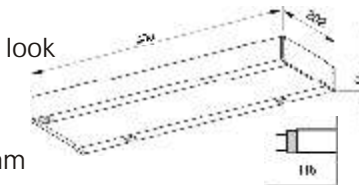

LD 6000 LB Series

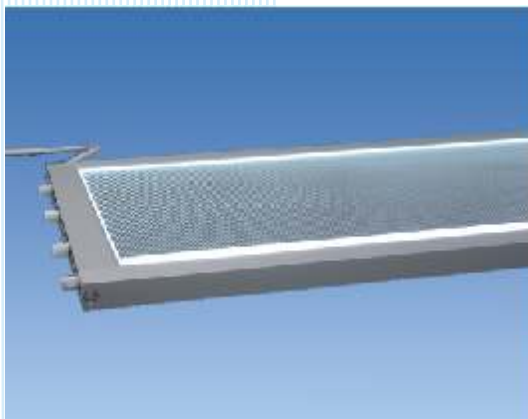

- Recessed light shelf 230V 50/60Hz
- dotted white glass
 - fluorescent tube T2/T7 \varnothing 7 mm, 4000° K
 - integrated electronic ballast
 - 16 mm profile
 - for 16 to 19 mm side panels, width/depth customised
 - approx. 300 mm supply lead with mini plug

E529 218 70 567x284/13W
E529 218 71 767x284/13W
E529 218 72 867x284/19W

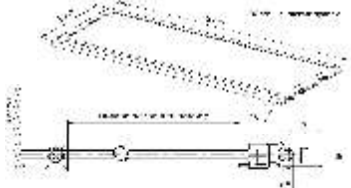

> Accessories



**Fluorescent tube 6W
Light Disc Opal**
230V/50-60Hz
- GX 53 base

E533442 51
- W840

light colour
cool white



**LED lamp 2, 7W
Light Disc LED**
230V/50-60Hz
- GX 53 base

E529290 01 white
- 6400°K



**Halogen bulb
QT 9**
- G4 base

E540094 36 12V/10W
E540094 33 12V/20W